



- Address:** 5578-5580 Sepulveda Boulevard, Culver City, CA 90230
- Available Space:** Approximately 3,700 square feet (divisible to 1,800 and 1,900 square feet).
- Parking:** Four (4) reserved single parking spaces in rear.
- Rental Rate:** \$2.80 NNN per square foot per month. Tenant to pay its pro-rata share of real property taxes, property and general liability insurance, currently 51¢ per square foot per month.
- Sublease Term:** Through September 30, 2021
- Comments:**
- ▶ Located near the high-trafficked intersection of Sepulveda and Jefferson Boulevards;
  - ▶ Neighbors include Westfield Culver City (over a million square foot regional mall anchored by Best Buy, JCPenney, Macy's, Nordstrom Rack and Target), Sprouts, BevMo!, Orchard Supply Hardware, Big Lots, Toys "R" Us, Pavilions, T.J. Maxx and many other established retailers and restaurants.



For further information  
or tour, please  
contact exclusive agents:

### Marc Pollock

License #00881177  
[Marc@WestsideRetail.com](mailto:Marc@WestsideRetail.com)

### Mark Einbund

License #00826287  
[Mark@WestsideRetail.com](mailto:Mark@WestsideRetail.com)

11847 Gorham Avenue  
Suite 120  
Los Angeles, CA 90049  
Phone 310.826.8000  
Fax 310.826.8333

Additional information on this  
property can be found online at  
[www.WestsideRetail.com](http://www.WestsideRetail.com)

5578-5580 SEPULVEDA BOULEVARD  
CULVER CITY, CA 90230

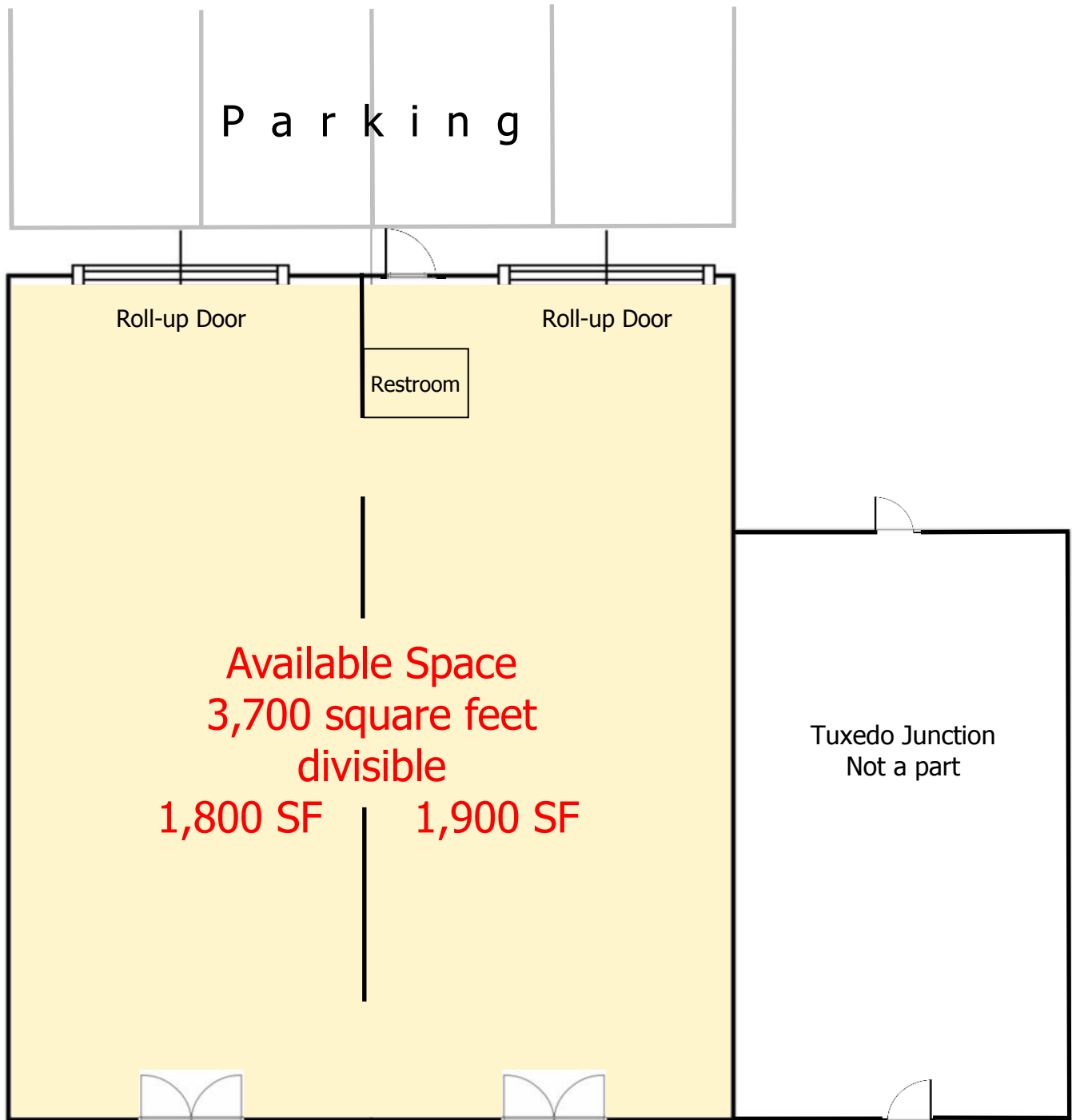

Sepulveda Boulevard