



- Address:** 9025 Santa Monica Boulevard, West Hollywood, CA 90069
- Available Space:** Approximately 3,400 square feet.
- Parking:** 6 parking spaces in rear.
- Asking Rate:** \$3.95 NNN per square foot per month. Tenant to pay real property taxes, property and general liability insurance, currently estimated at 35¢ per square foot per month.
- Comments:**
- ▶ Located just East of Doheny Drive and steps from the City of Beverly Hills;
 - ▶ Close in proximity to the Pacific Design Center, Sunset Plaza and The Palm Restaurant;
 - ▶ Also available for home furnishings showroom or gallery.

For further information
or tour, please
contact exclusive agents:

Marc Pollock

License #00881177
Marc@WestsideRetail.com

Stacy Shakib

License #01851022
Stacy@WestsideRetail.com

11847 Gorham Avenue
Suite 120
Los Angeles, CA 90049
Phone 310.826.8000
Fax 310.826.8333



Additional information on this
property can be found online at
www.WestsideRetail.com

**9025 SANTA MONICA BOULEVARD
WEST HOLLYWOOD, CA 90069
(PROPOSED RESTAURANT LAYOUT)**

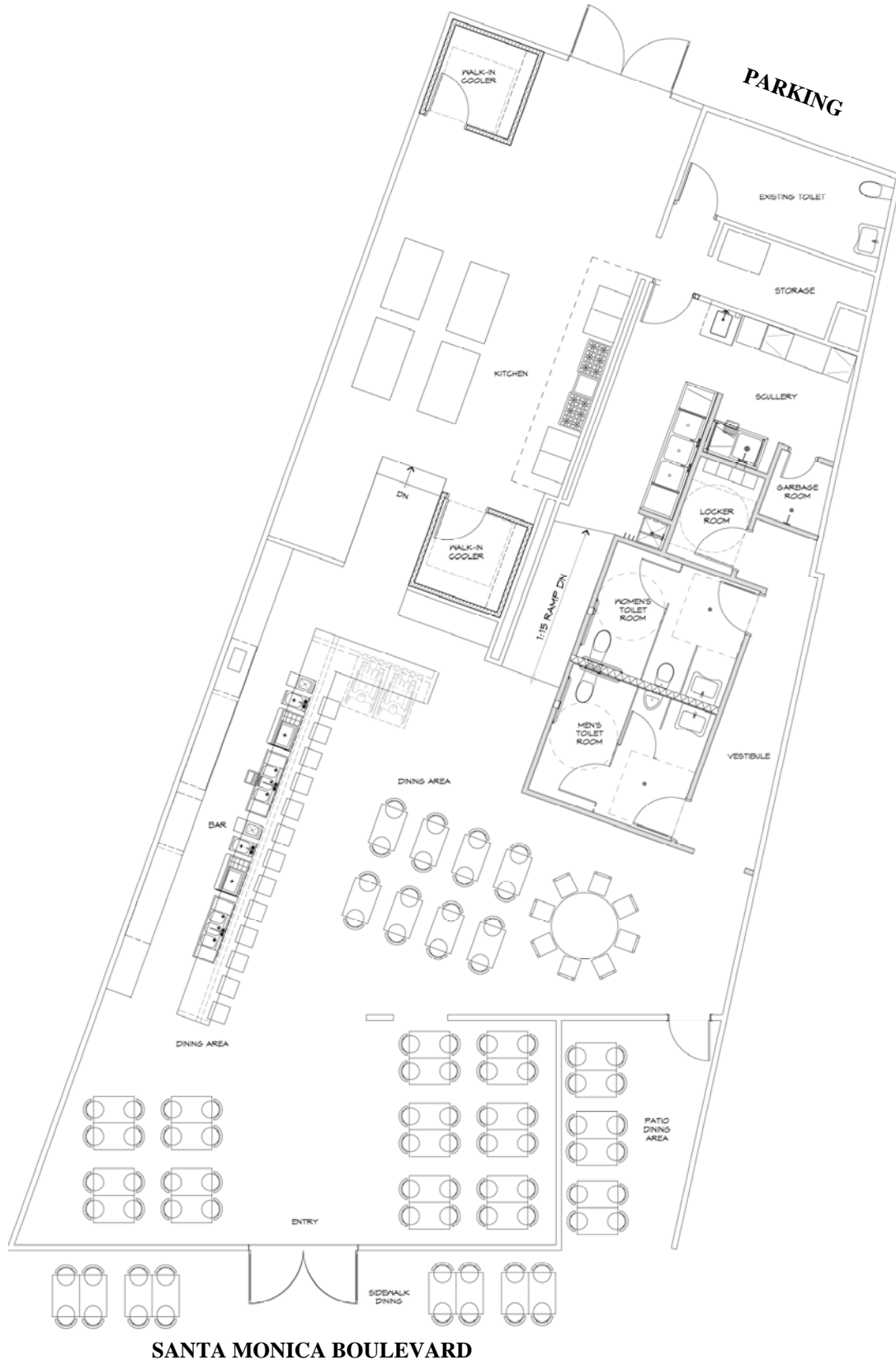

The information contained on this site plan is for illustration purposes only, not drawn to scale, and not intended to make any representation or warranty as to the actual number of parking spaces, or to the size, nature of improvements, identity or location of any existing or proposed tenant(s). It is your responsibility to independently confirm its accuracy and completeness. You and your advisors should conduct a careful and independent investigation to determine to your satisfaction the suitability of the property for your needs. Westside Retail, Inc. 2012