

1786-1790 Westwood Boulevard

West Los Angeles, California

FOR SALE OR LEASE

For further information or tour,
please contact exclusive agents:

Team Pollock/Einbund

Marc Pollock

First Vice President

310.550.2600

marc.pollock@cbre.com

Mark Einbund

First Vice President

310.550.2565

mark.einbund@cbre.com

CB Richard Ellis, Inc.
1840 Century Park East
Suite 700
Los Angeles, CA 90067

main: 310.550.2500

fax: 310.550.2691



GREAT OWNER/USER/INVESTMENT OPPORTUNITY . . .

CURRENT AVAILABILITY:	Approximately 5,132 square feet (3,752 square feet on ground level, 1,380 square feet on mezzanine level)
TOTAL BUILDING SIZE:	Approximately 7,457 square feet
LOT SIZE:	Approximately 12,362 square feet
ASKING LEASE RATE:	\$2.75 NNN per square foot per month ground level \$1.50 NNN per square foot per month mezzanine level
ASKING SALE PRICE:	\$2,695,000 (\$361.40 per square feet of building)
PARKING:	25 parking spaces with 9 additional shared

HIGHLIGHTS

- ▶ Lease for 2,325 square feet with PC Club expires 9/30/05;
- ▶ Rare, free-standing Westside buildings with convenient parking;
- ▶ Excellent visibility and roof signage;
- ▶ Tremendous traffic count: Approximately 91,172 cars per day at Westwood and Santa Monica Boulevards;
- ▶ Great central location between UCLA, 405 San Diego Freeway, Westside Pavilion Mall and Century City Shopping Center;
- ▶ Neighborhood retailers include Ross Dress for Less, Bristol Farms Market, Borders Books, Cost Plus Imports, and many other fine retailers and restaurants.

Additional information on this
offering can be viewed at
www.WestsideRetail.com

CBRE
CB RICHARD ELLIS

© 2004 CB Richard Ellis, Inc. The information above has been obtained from sources believed reliable. While we do not doubt its accuracy, we have not verified it and make no guarantee, warranty or representation about it. It is your responsibility to independently confirm its accuracy and completeness. Any projections, opinions, assumptions or estimates used are for example only and do not represent the current or future performance of the property. The value of this transaction to you depends on tax and other factors which should be evaluated by your tax, financial and legal advisors. You and your advisors should conduct a careful, independent investigation of the property to determine to your satisfaction the suitability of the property for your needs.

1786-1790 Westwood Boulevard

West Los Angeles, California

FOR SALE OR LEASE

For further information or tour,
please contact exclusive agents:

Team Pollock/Einbund

Marc Pollock

First Vice President

310.550.2600

marc.pollock@cbre.com

Mark Einbund

First Vice President

310.550.2565

mark.einbund@cbre.com

CB Richard Ellis, Inc.
1840 Century Park East
Suite 700
Los Angeles, CA 90067

main: 310.550.2500

fax: 310.550.2691

SITE PLAN

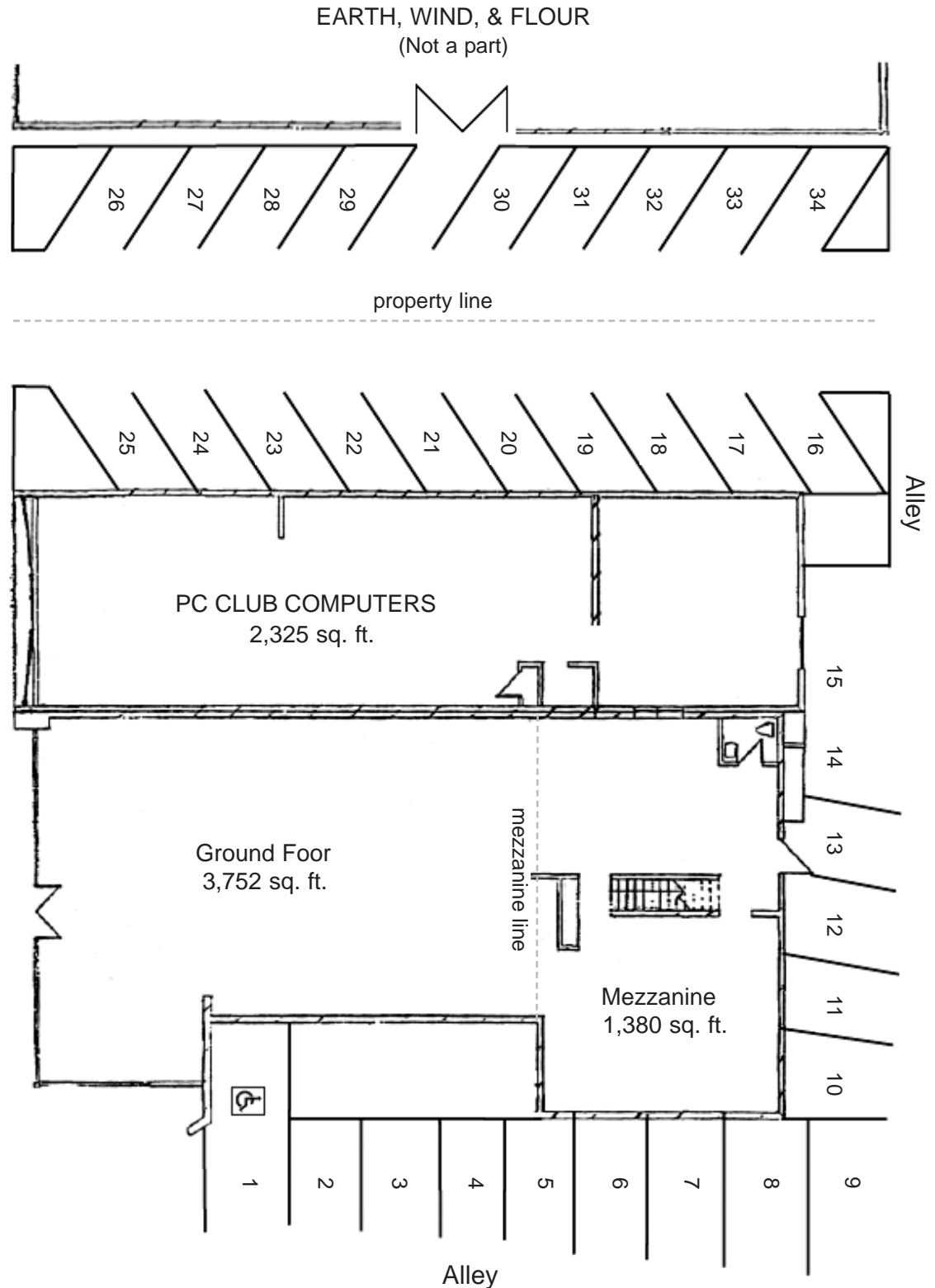

Additional information on this
offering can be viewed at
www.WestsideRetail.com

CBRE
CB RICHARD ELLIS

© 2004 CB Richard Ellis, Inc. The information above has been obtained from sources believed reliable. While we do not doubt its accuracy, we have not verified it and make no guarantee, warranty or representation about it. It is your responsibility to independently confirm its accuracy and completeness. Any projections, opinions, assumptions or estimates used are for example only and do not represent the current or future performance of the property. The value of this transaction to you depends on tax and other factors which should be evaluated by your tax, financial and legal advisors. You and your advisors should conduct a careful, independent investigation of the property to determine to your satisfaction the suitability of the property for your needs.